



tel.: +48 (58) 340 24 40  
 fax: +48 (58) 340 24 49  
 e-mail: [info@alarmtech.pl](mailto:info@alarmtech.pl)

Alarmtech Polska Sp. z o.o.  
 ul. Kielnińska 115  
 80-299 Gdansk-Osowa, Poland

## MC 240-S78

### MC 240-S78 SET: MAGNETIC REED & CONTACT IN ALUMINUM HOUSING

The MC 240-S78 is a surface-mount set for mounting on steel or iron doors, gates etc. It includes a magnetic reed MC 240-C enclosed in an MC 200-7 Al housing and an extra strong magnet in an MC 200-8 housing to allow contact actuation with wider gaps. The MC 240-S68 set can be used with an MC 200-T armoured sleeving accessory.

#### TECHNICAL DATA

- Reed relay switch configuration: NC
- Contact rating: max. 200 V DC/peak AC/500 mA/10 VA
- Anti-tamper loop
- 6 m, 4 wire, white lead, VdS approved
- Magnet material: Alnico 5
- Approved by Techom, VdS, ANPI/NVBB and other European certification bureaus.

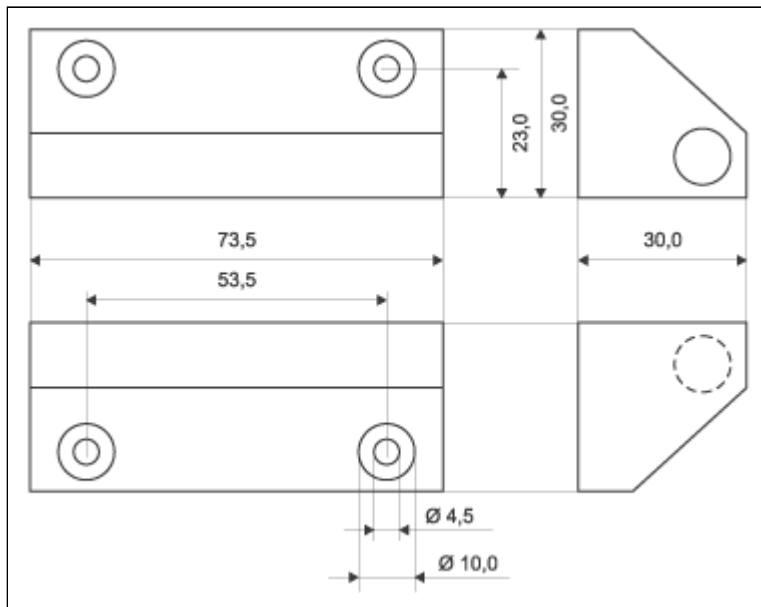

PRODUCT CODE	PRODUCT DESCRIPTION	GAP DISTANCE - WOOD	GAP DISTANCE - STEEL	PACKAGING
MC 240-S78	MC 240-C magnetic reed housed in the MC 200-7 + magnet housed in the MC 200-8 + 6 m, white, 4 wire lead	45 mm	33 mm	1 set